

ZXL30i-WM

LED Wall Mount · ZX30 Series



Product Features

- Fixed angle wall mount up light or down light with mounting canopy.
- ETL outdoor wet location listed. IP65 standard.
- Machined from solid billet 6061-T6 corrosion resistant aluminum.
- Swivel stem insert allows for precision adjustment during installation.
- Unique weep hole design in hood allows for either upward or downward facing installation with minimum light leak.
- Modular components - field changeable LED module & beam spread reflectors.
- Available in turtle friendly amber model.

Specification

Materials: Machined from billet 6061-T6 corrosion resistant aluminum with 304 stainless steel hardware. Available in 304/316 stainless steel or 360 brass upon request.

Hood and Glare Shield: 3 available hood options to suit any application. 3 optional glare shields (short, long, angled) to complement each hood choice. See page 3 for details.

Voltage: 120~277V AC with integral LED driver.

Wattage: 28W Nichia LED. Amber 23W or 24W Xicato LED.

Light Source: CRI 83. Available in CRI95 upon request. The chromaticity range is within a 3-step McAdam Ellipse. Standard CCT options are 2700K, 3000K, 4000K.

Lamp Base/Socket: Innovative cone-shaped lamp base and receptacle socket maximize the surface contact area to dissipate heat more effectively. See "Resources" for details.

Dimmability: Standard with Phase dimming@120V, 0~10V dimming@120V~277V.

Finish: Polyester powder coat on all aluminum materials with RoHS compliant procedures. Anodized finish is available. Stainless steel and brass models are provided with brushed surface.

Optical Accessories: Accepts up to 3 accessories (hexcel louver, optical lenses, dichroic color filters, etc.). Secured in place with metal snap ring.

Mounting Accessory: Utilizes 2x 8-32 UNC machine screws (provided) to attach to a standard octagon recessed back box (provided by others).

Ordering Guide

EXAMPLE: ZXL30i-WM - A - GSL - UNV - N28 - 27 - 20 - 010 - BK - LVR - CM5

SERIES	MATERIAL	HOOD	OPTIONAL GLARE SHIELD	VOLTAGE	WATTAGE	CCT	OPTICS	OPTIONAL DIMMING	FINISH	OPTIONAL SELECT UP TO 3 OPTIC ACCESSORIES	OPTIONAL MOUNTING ACCESSORIES
ZXL30i-WM	-	-	-	UNV	-	-	-	-	-	-	-
	BLANK Aluminum(Standard) NBR Natural Brass NSS Natural Stainless Steel CU Natural Copper	A A-HOOD B B-HOOD C C-HOOD	GSL GSA GSS CGSL CGSA CGSS	120~277V	N28 28W X24 24W AMB 23W	27 2700K 30 3000K 40 4000K AMBER	20 20° 30 30° 40 40°	PH Phase Dimming @120V 010 0~10V Dimming @120~277V	Standard BK Black Powder Coat BZ Bronze Powder Coat WT White Powder Coat Premium ABK Anodized Black ACL Anodized Clear CC Custom Powder Coat	LVR Hexcel Louver OSL Overall Spread Lens LSL Linear Spread Lens SOL Solite Soft Focus DF Dichroic Filter	See page 3 for quick reference or "Accessories" link for detailed specification.

Product Drawings

NOTE: Specification and dimensions subject to change without notice.

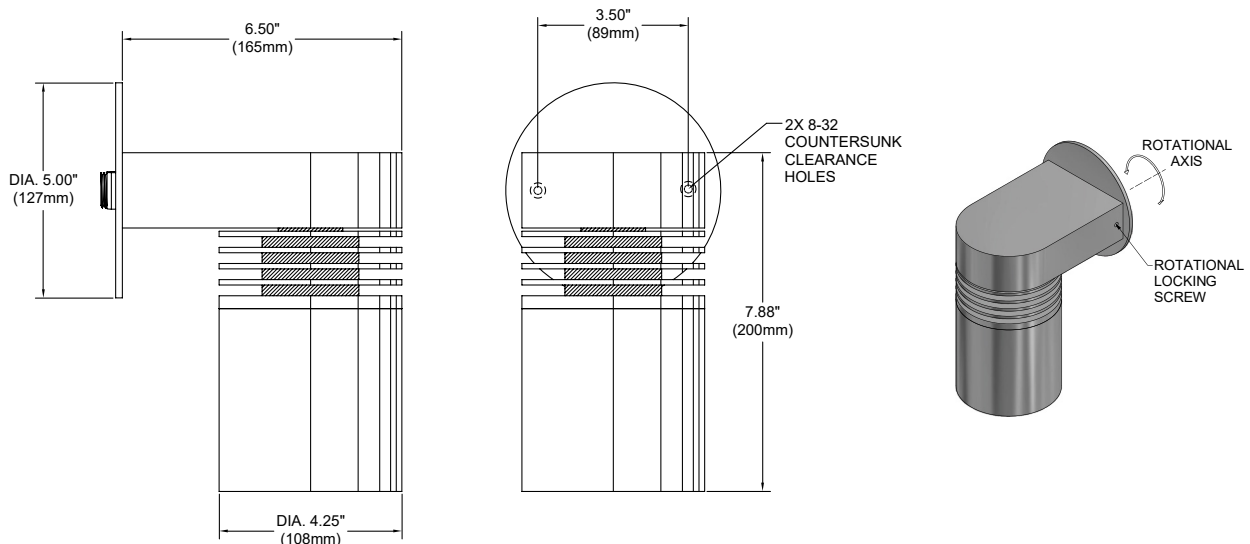

Photometry & Energy Data

MODEL ZXL-30i-WM-N28-N

Input Power	28W
Color Temperature (CCT)	3000K
Color Rendering Index (Ra)	83
Beam Angle	20.0°
Max. Candlepower	15398cd
Delivered Lumens	2738lm
Efficacy	98lm/W

Polar Graph - Intensity

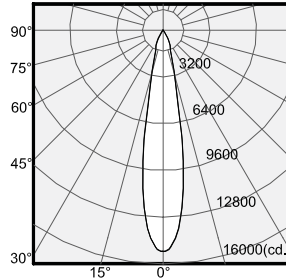

Cone of Light - Illuminance

Center Beam (fc)	Beam Diameter	Distance
3779	0.7'	2.0'
945	1.4'	4.0'
420	2.1'	6.0'
236	2.8'	8.0'
151	3.5'	10.0'

1/2 Beam Angle: 20.0°

MODEL ZXL-30i-WM-N28-M

Input Power	28W
Color Temperature (CCT)	3000K
Color Rendering Index (Ra)	83
Beam Angle	29.4°
Max. Candlepower	7827cd
Delivered Lumen	2503lm
Efficacy	89lm/W

Polar Graph - Intensity

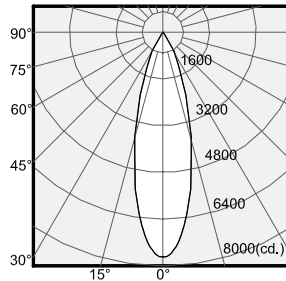

Cone of Light - Illuminance

Center Beam (fc)	Beam Diameter	Distance
1921	1.0'	2.0'
480	2.1'	4.0'
213	3.1'	6.0'
120	4.2'	8.0'
77	5.2'	10.0'

1/2 Beam Angle: 29.4°

MODEL ZXL-30i-WM-N28-W

Input Power	28W
Color Temperature (CCT)	3000K
Color Rendering Index (Ra)	83
Beam Angle	37.5°
Max. Candlepower	5476cd
Delivered Lumen	2598lm
Efficacy	93lm/W

Polar Graph - Intensity

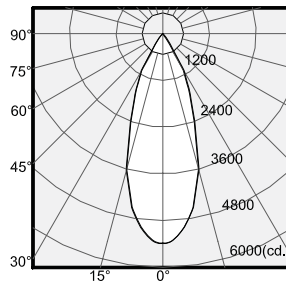

Cone of Light - Illuminance

Center Beam (fc)	Beam Diameter	Distance
1344	1.4'	2.0'
336	2.7'	4.0'
149	4.1'	6.0'
84	5.4'	8.0'
54	6.8'	10.0'

1/2 Beam Angle: 37.5°

Multiplier Table for above data

Type	Wattage	Multiplier
N28	28Watt	1.00
X24	24Watt	0.69
AMBER	23Watt	0.50

CCT Multiplier Table

Color Temp.	Multiplier
2700k	0.97
3000k	1.00
4000k	1.05

Multiplier Table for IES Files (Taken from IES of ZXL30i-51.8W)

Type	Multiplier
N28	0.78
X24	0.54
AMBER	0.39

Product Options & Accessories

Hood Options

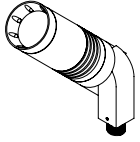

A-HOOD
Versatile hood with 8 weep holes for water drainage. Regressed lens for glare control. Suggested for general use or when fixture is aimed in an up position.

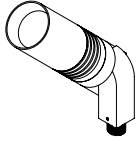

B-HOOD
Similar to A hood but without weep holes. Regressed lens for glare control. Used in an interior or down light application.

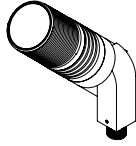

C-HOOD
Flush hood with machined threading on the outside for attachment of C-style glare shield, cleverly designed with hidden drainage channels.

Optional Glare Shield

For Use With A & B Hood
Fastened With Set Screw



GSA
(angle)



GSL
(long)



GSS
(short)



For Use With C Hood
Fastened With Locking Ring



CGSA
(angle)



CGSL
(long)



CGSS
(short)



Mounting Accessories

Canopy Plate:

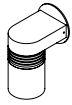

Fixture On CM5

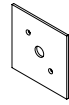

CM3



CM5

Surface Mount Box:

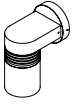

Fixture On CB5.1



CB5.1

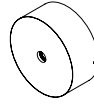

CB5.5

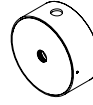

CB5.5-K/O

Notes