

LED WALL MOUNT

MODEL ZXL30i-WM2

The ZXL30i Wall Mount 2 is a very compact quality lighting solution for up/down light illumination in an architectural or landscape application. Designed with a modernist edge, it is machined from anti-corrosion silicone magnesium aluminum alloy.

- Field replaceable LED module and reflectors
- Equipped with integral LED drivers, this line-voltage fixture is ready to operate.
- Listed for Indoor/Outdoor/Wet location application
- Heat dissipation greatly enhanced by integrating the fixture body as part of the heat sink; ensures long LED life
- Ozone, aging, and weather-resistant silicone shore 70 and 40 O-rings used to hermetically seal and protect the fixture
- Recessed light source for glare reduction
- Consult factory for dimming

Specifications

SERIES	ZXL
MODEL	30i-WM2
MATERIAL ¹	<i>Housing/Cap/Stem</i> Machined silicone magnesium aluminum alloy (6061-T6) resistant to corrosion. Stainless steel (SS304) hardware.
VOLTAGE	100-277 Volt AC
WATTAGE	19 / 22.3 Watt x 2
LAMP ²	LED Module 2700/3000/4000K (Field replaceable)
BEAM SPREAD ³	Narrow/Medium/Wide
FITTING	1/2" NPS threaded male fitting
FINISHES ⁴	Anodized Black (ABK) Anodized Clear (ACL) Powder Coated Paint Black (BK) Powder Coated Paint Bronze (BZ) Powder Coated Paint White (WT)

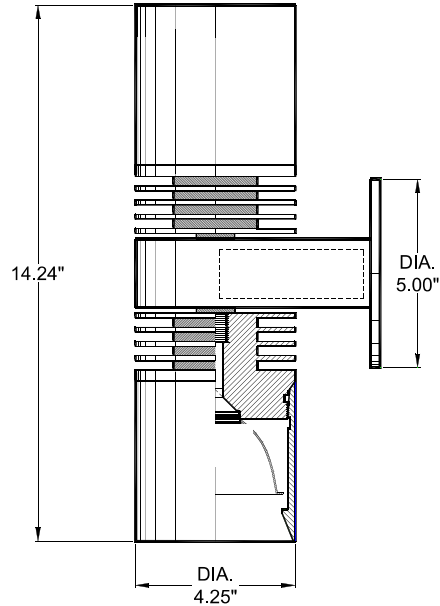

¹ Brass and stainless steel versions available upon request

² For various color combinations, please contact the factory

³ Selection by lens/reflector combination

⁴ For custom colors please contact the factory

Specifications and dimensions are subject to change without notice.

Ordering Guide

Series	Hood	Color Temp	Wattage	Beam Spread	Voltage	Finish
ZXL30i-WM2	A	2700 K	19W x2	N (Narrow)	100-277V	ABK
	B	3000 K	22.3Wx2	M (Medium)		ACL
		4000 K		W (Wide)		BK
						BZ
						WT

EXAMPLE ZXL30i-WM2 - B - 3K - 11.3Wx2 - M - 277V - ACL



PROJECT

FIXTURE TYPE